



PUBLICATION dans le cadre de l'Article L.49
du Code des Postes et Communications Électroniques

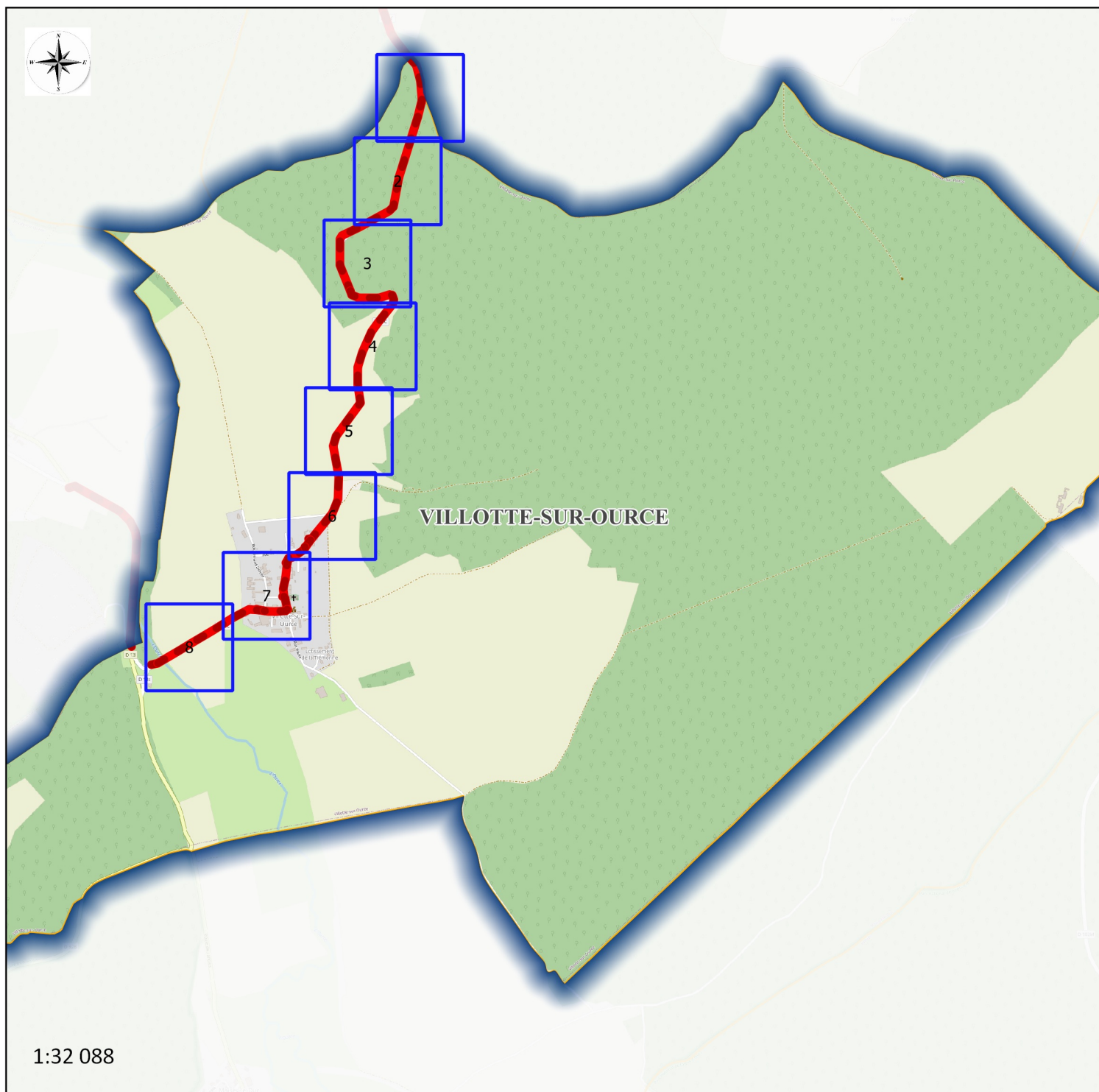

Figure 1 : vue d'ensemble du Génie Civil à réaliser sur la commune de VILLOTTE-SUR-OURCE

1. CONTACT :

Maître d'ouvrage :

Conseil Départemental de Côte-d'Or

**Pôle Aménagement et Développement des Territoires
Mission Aménagement numérique**

**1, rue Joseph Tissot
B.P. 1601 – 21035 Dijon Cedex**

Chargé d'affaires Mission Aménagement numérique :

**M. Frédéric POURNIN
Tel : 03 80 63 67 12
e-courriel : frederic.pournin@cotedor.fr**

Synoptique GC
D13C

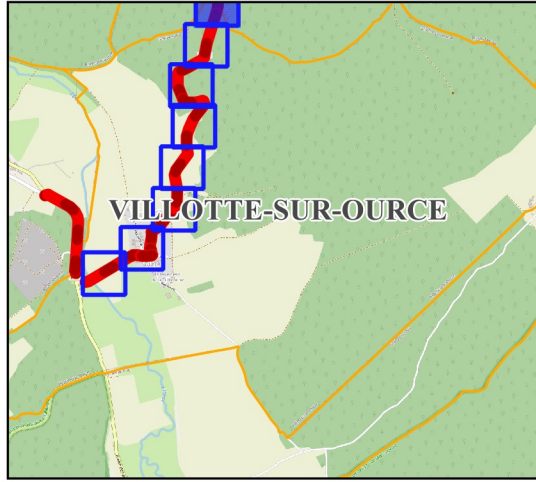

Légende :

GC

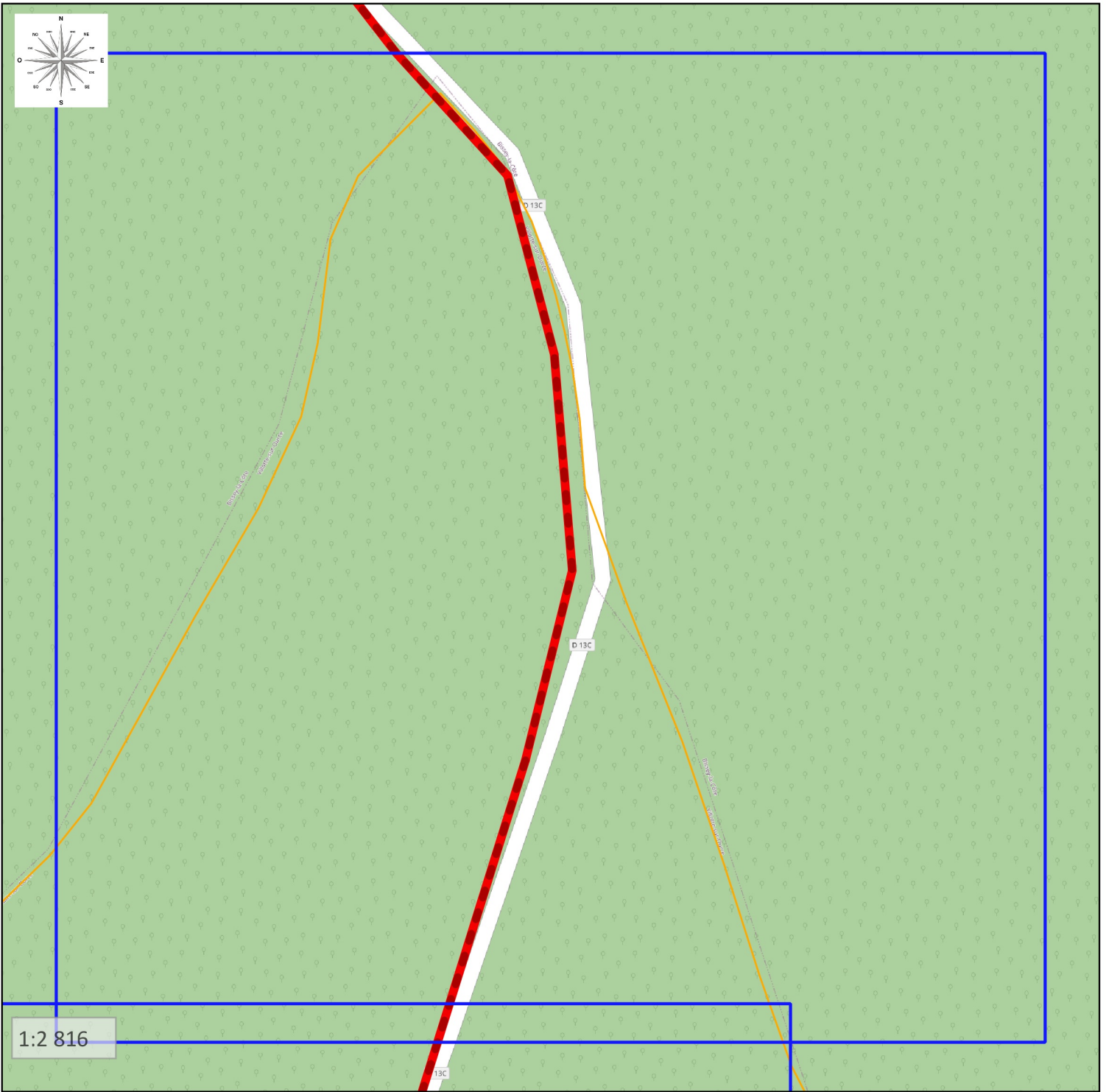

1:2 816

Synoptique GC
D13C

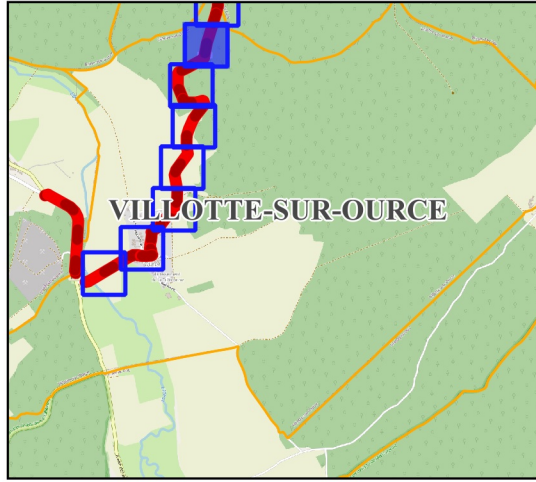

Légende :

GC

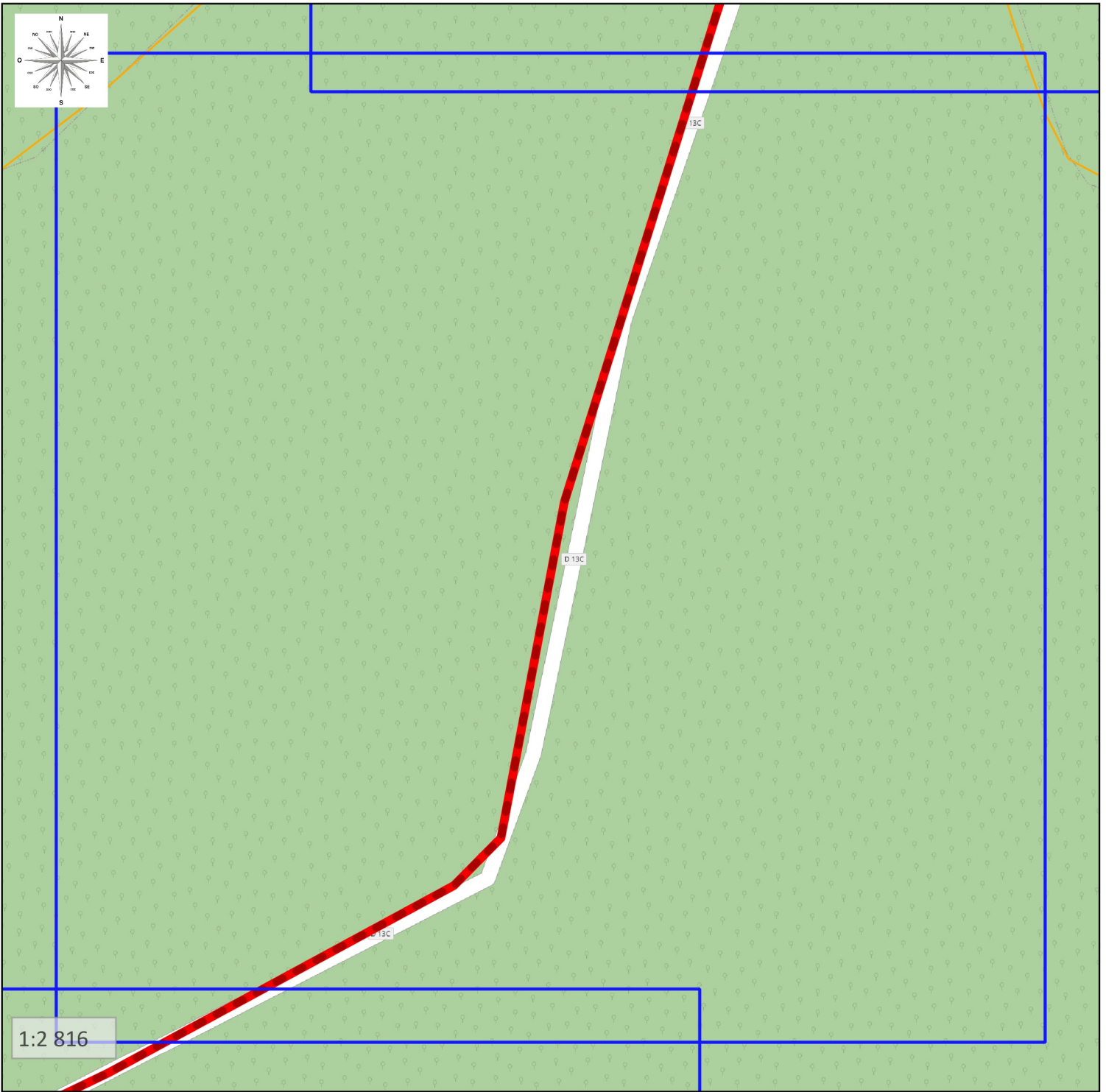

1:2 816

Synoptique GC
D13C

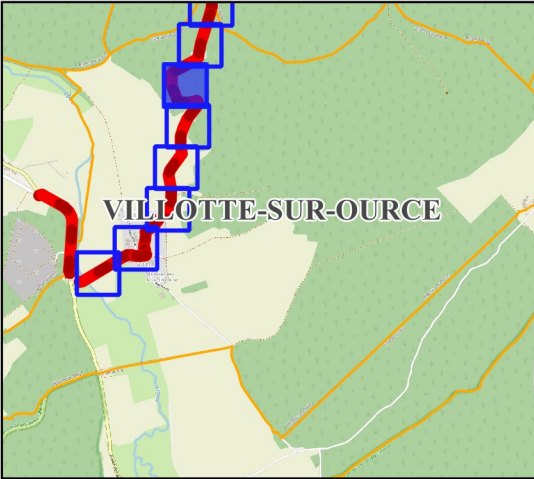

Légende :

GC

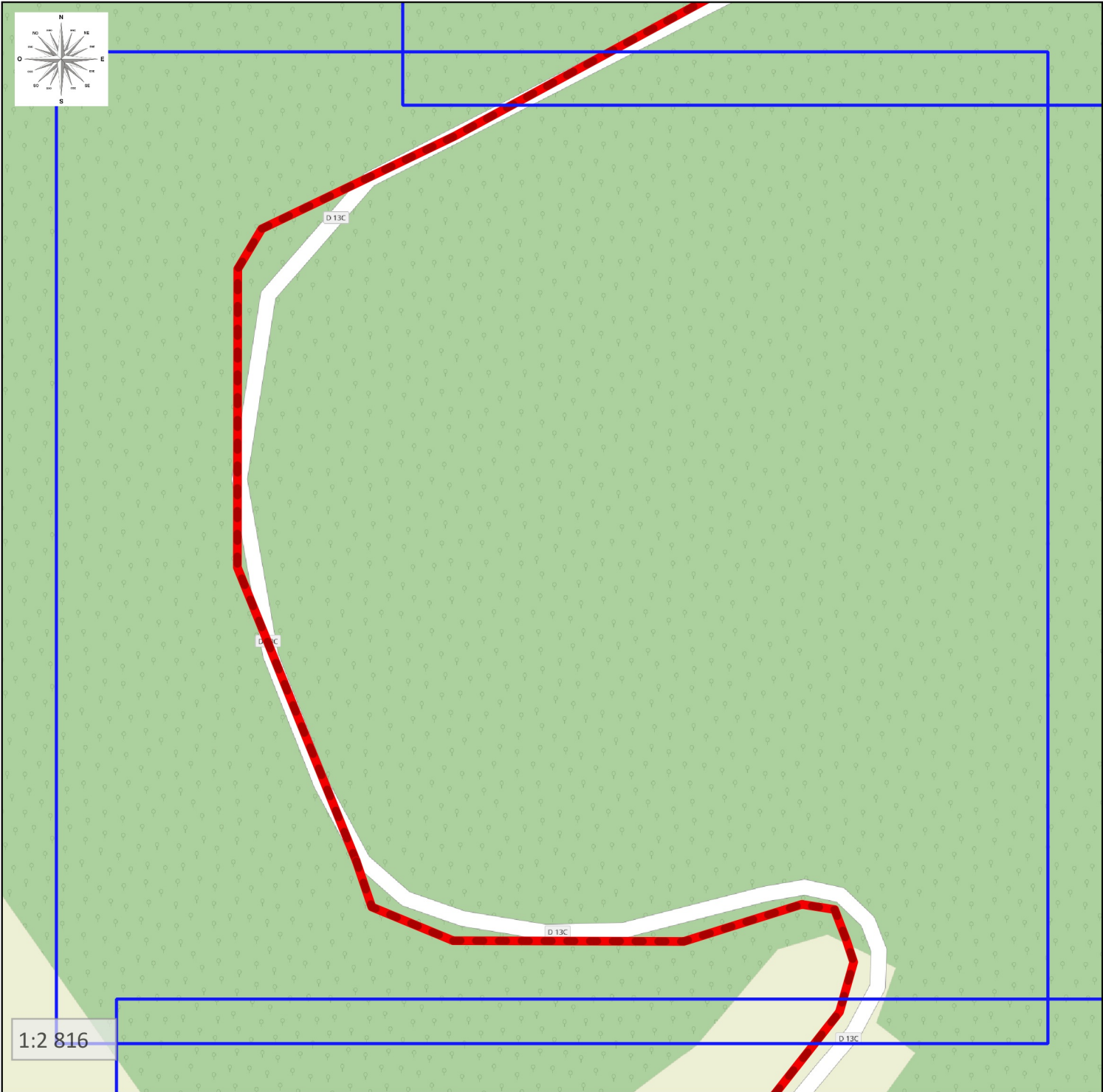

Synoptique GC
D13C

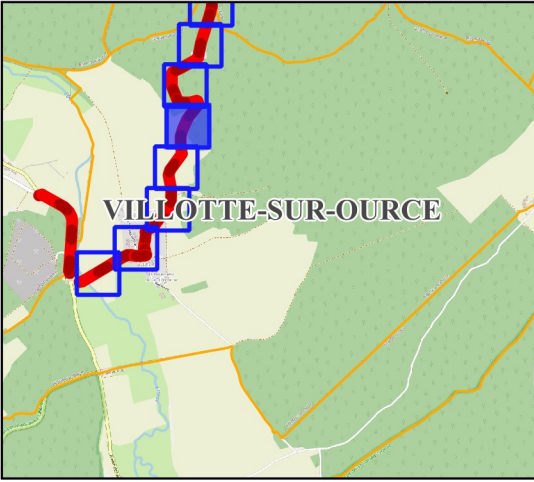

Légende :

GC

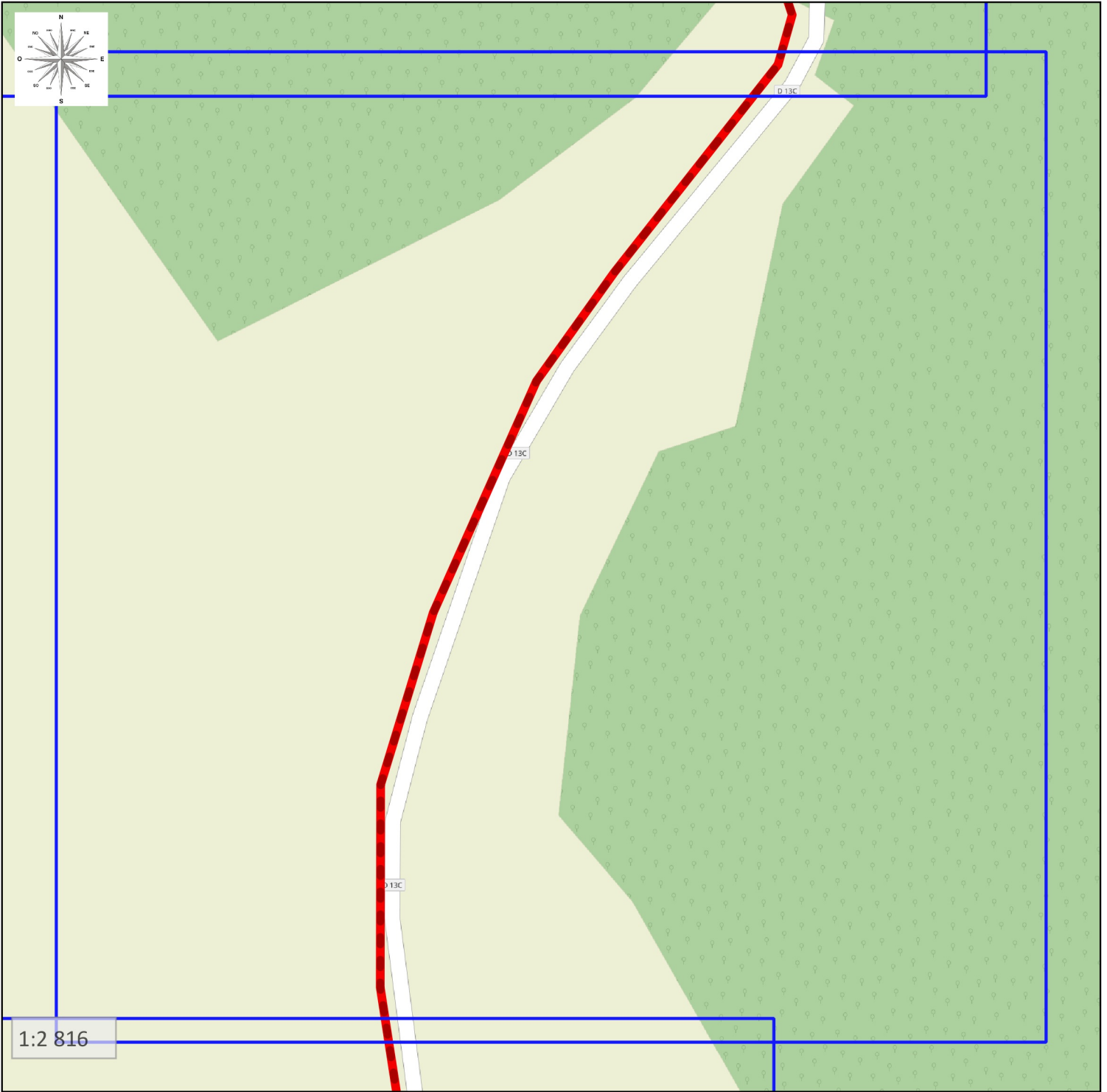

Synoptique GC
D13C

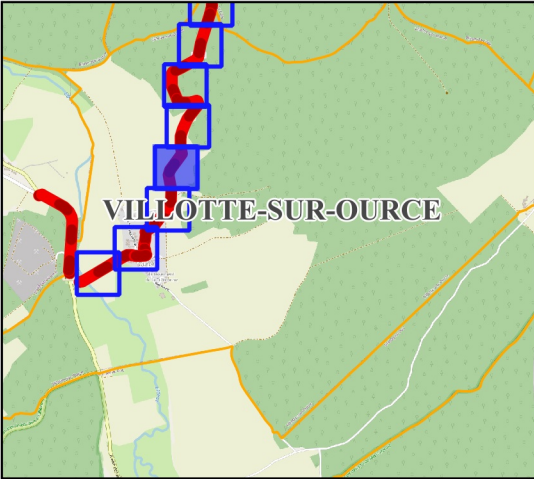

Légende :

GC

The legend indicates that the red line represents the GC (Grand Canal). It consists of a red line segment followed by the text 'GC'.

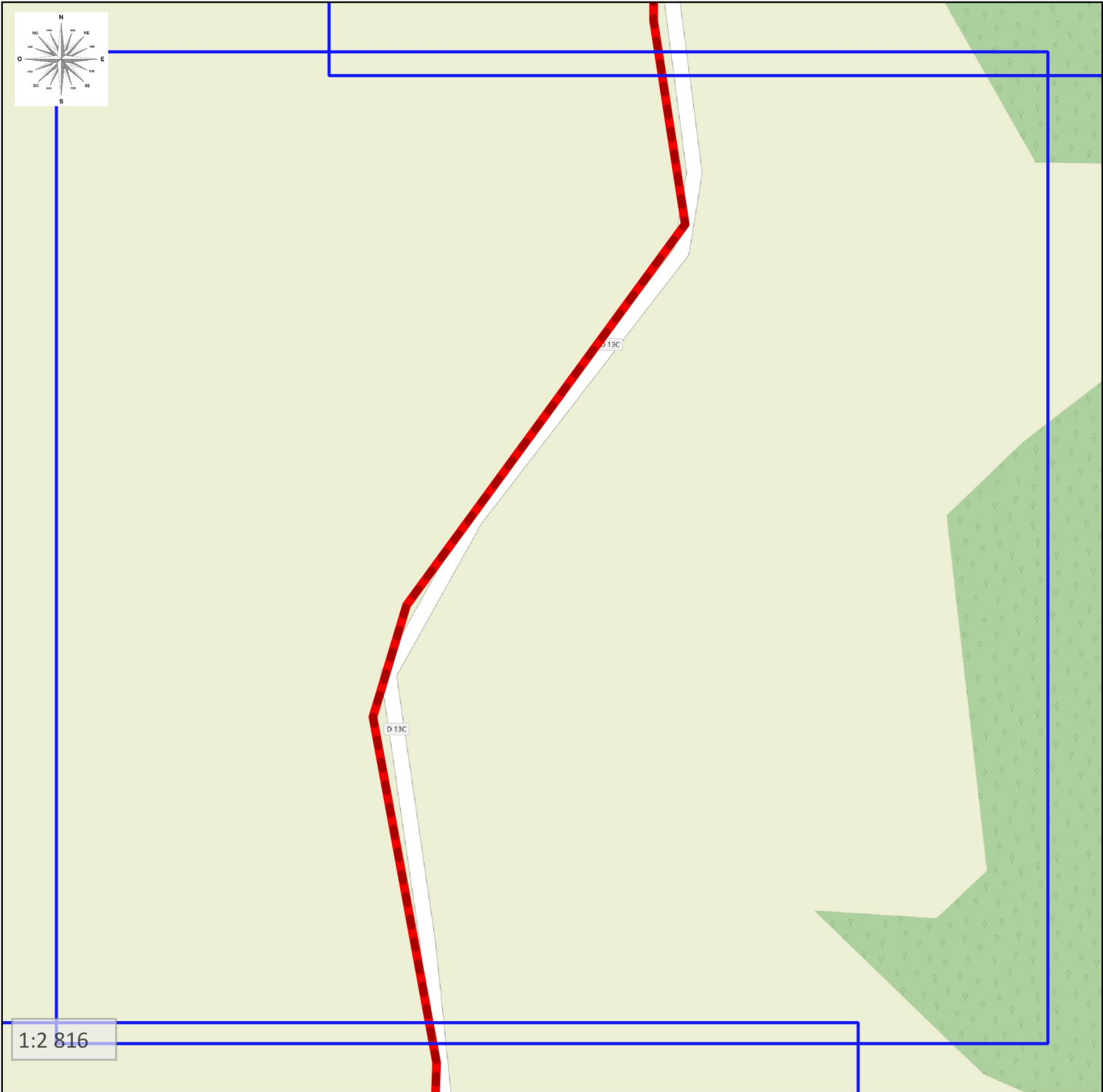

Synoptique GC
D13C

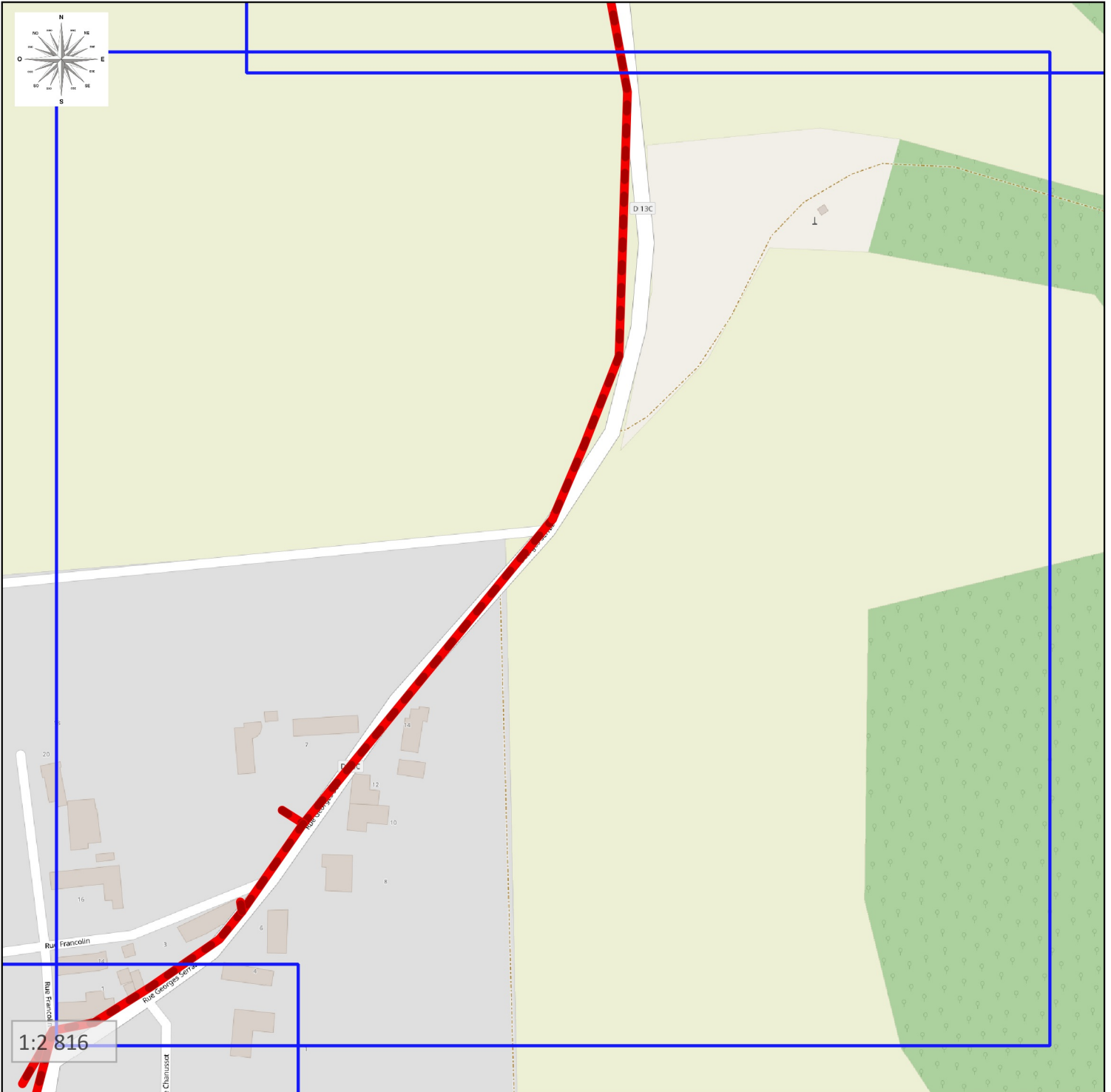
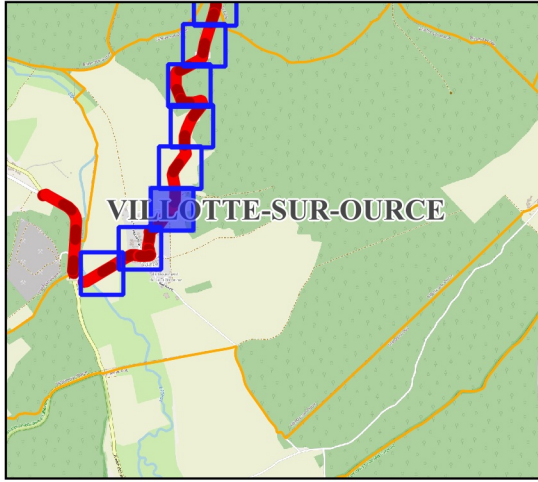

Synoptique GC D13C

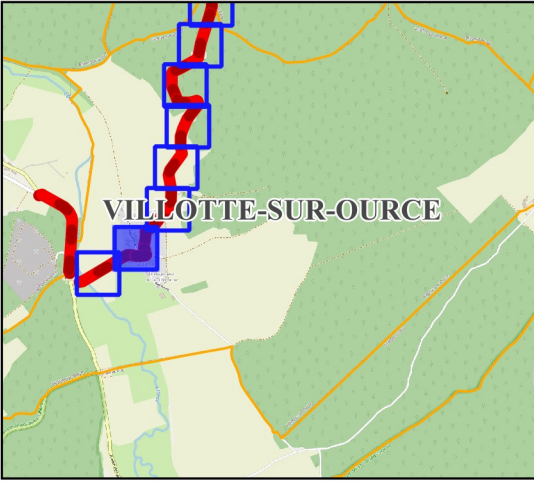

Légende :

 GC

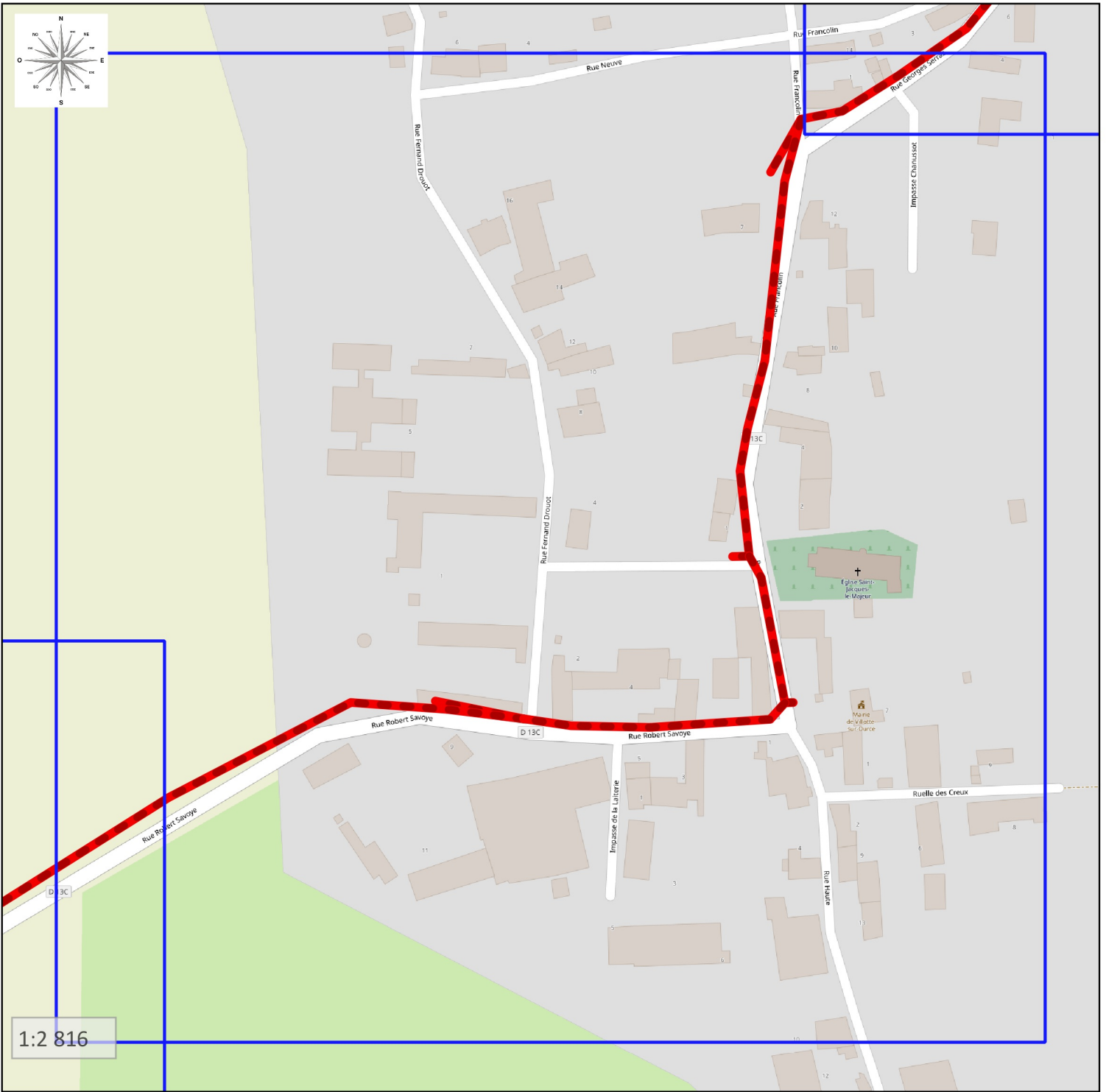

Synoptique GC
D13C

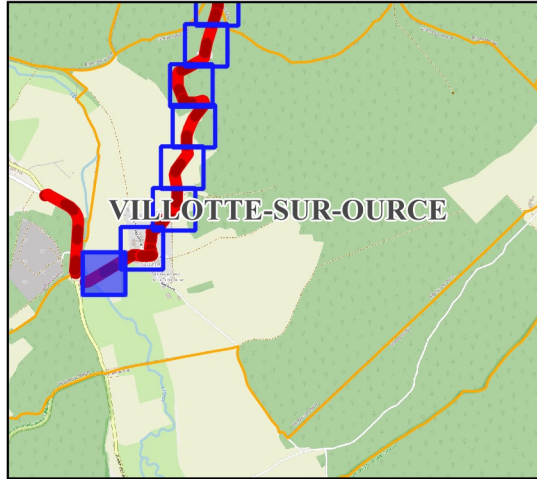

Légende :

GC

