

Figure 1 : vue d'ensemble du Génie Civil à réaliser sur la commune de CHAUME-LES-BAIGNEUX

1. CONTACT :

Maître d'ouvrage :

Conseil Départemental de Côte-d'Or

**Pôle Aménagement et Développement des Territoires
Mission Aménagement numérique**

**1, rue Joseph Tissot
B.P. 1601 – 21035 Dijon Cedex**

Chargé d'affaires Mission Aménagement numérique :

**M. Frédéric POURNIN
Tel : 03 80 63 67 12
e-courriel : frederic.pournin@cotedor.fr**

Synoptique GC
D21C

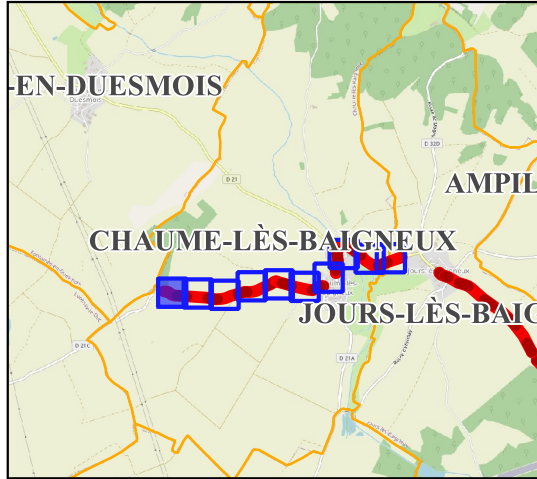

Légende :

GC

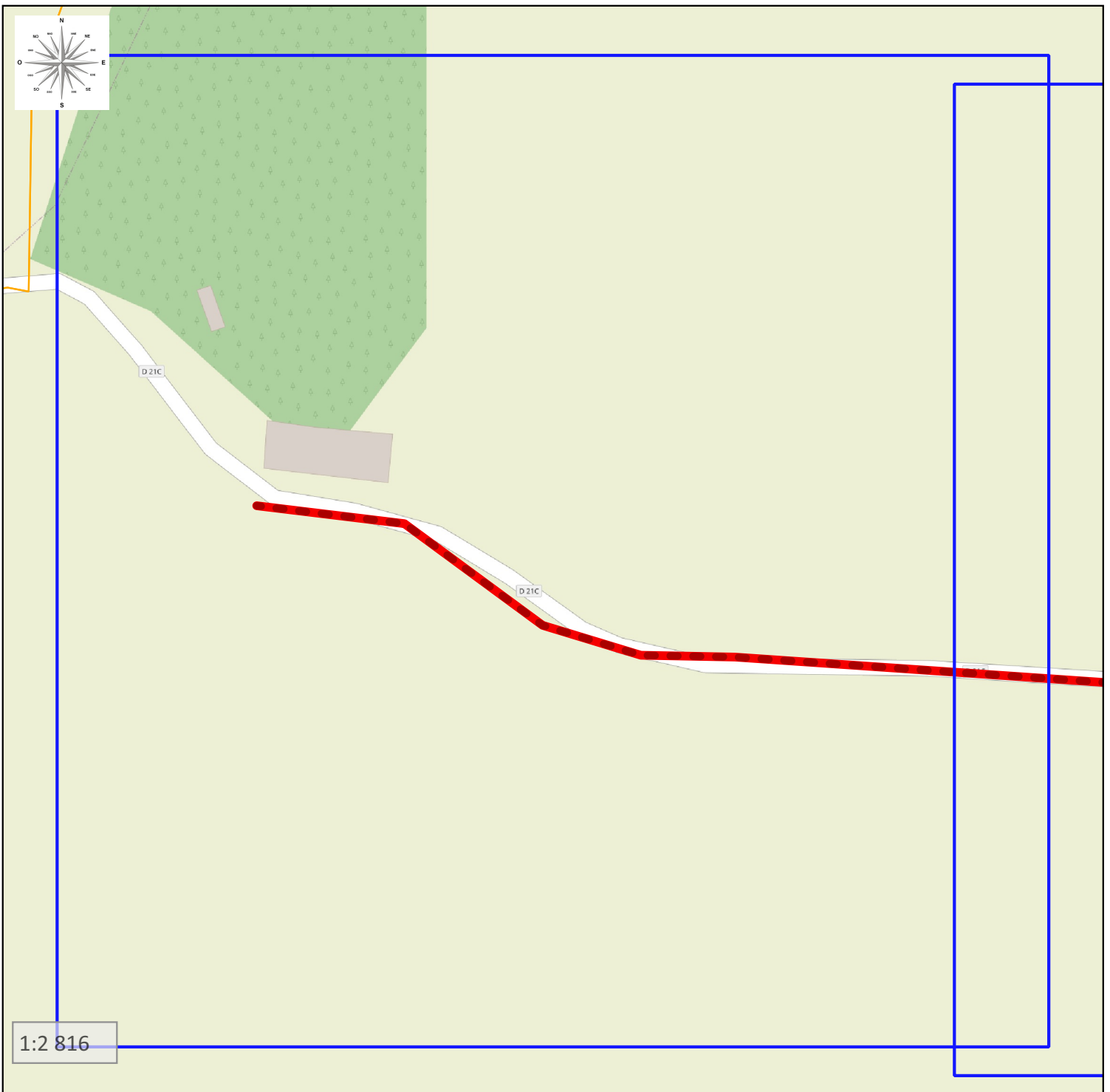

Synoptique GC
D21C

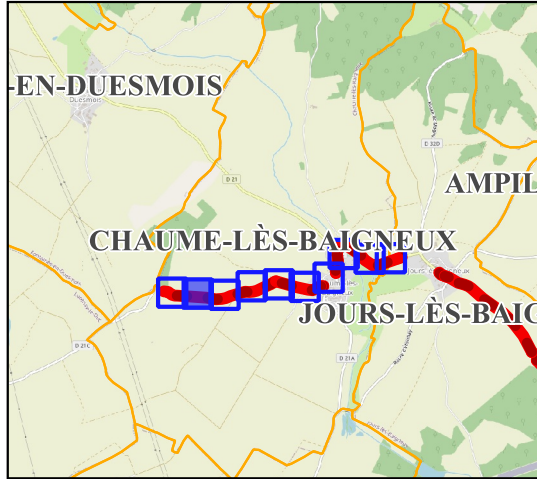

Légende :

GC

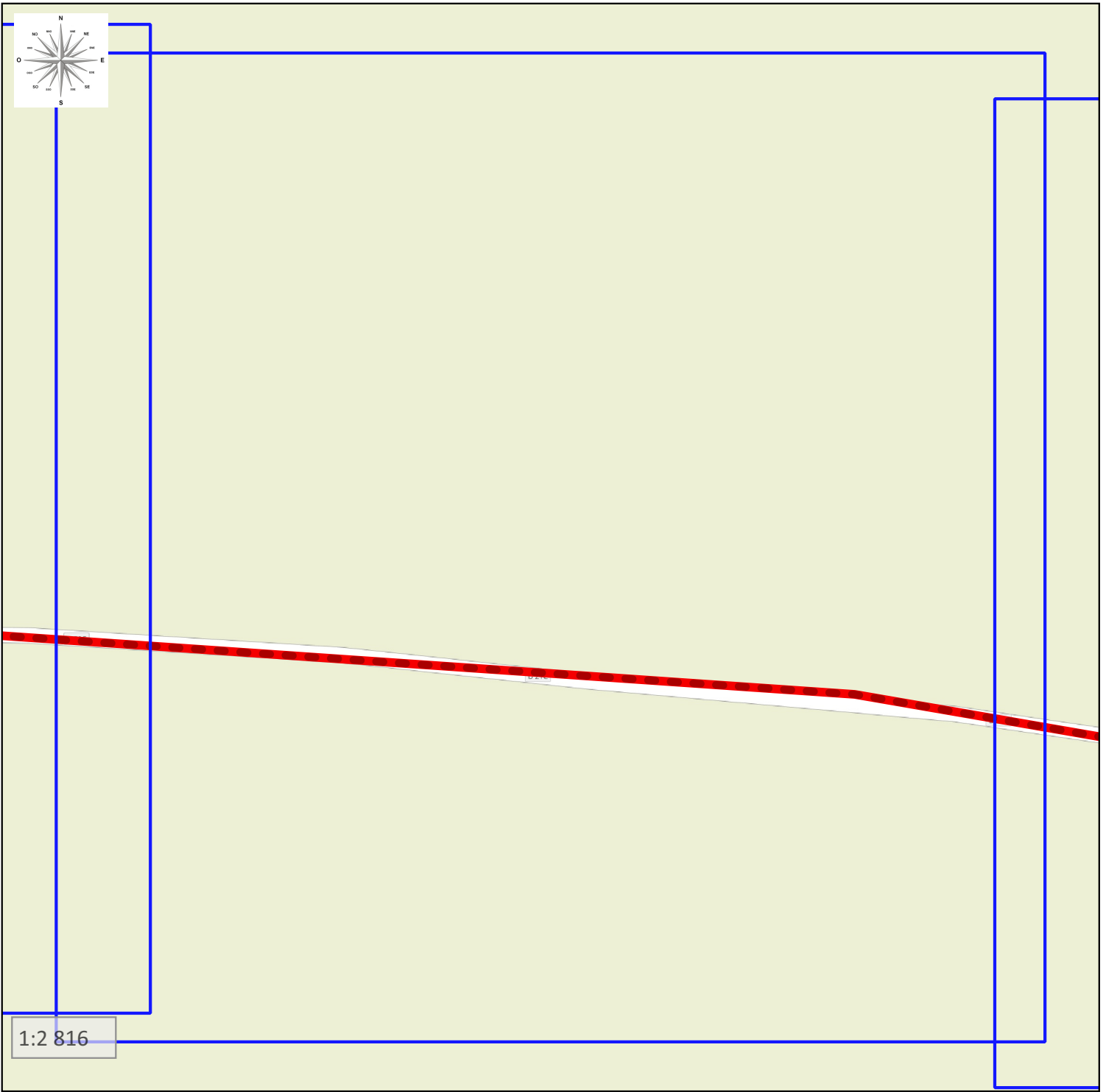

1:2 816

Synoptique GC
D21C

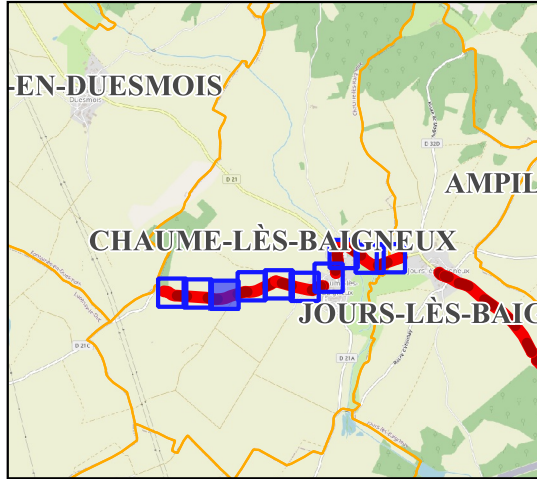

Légende :

GC

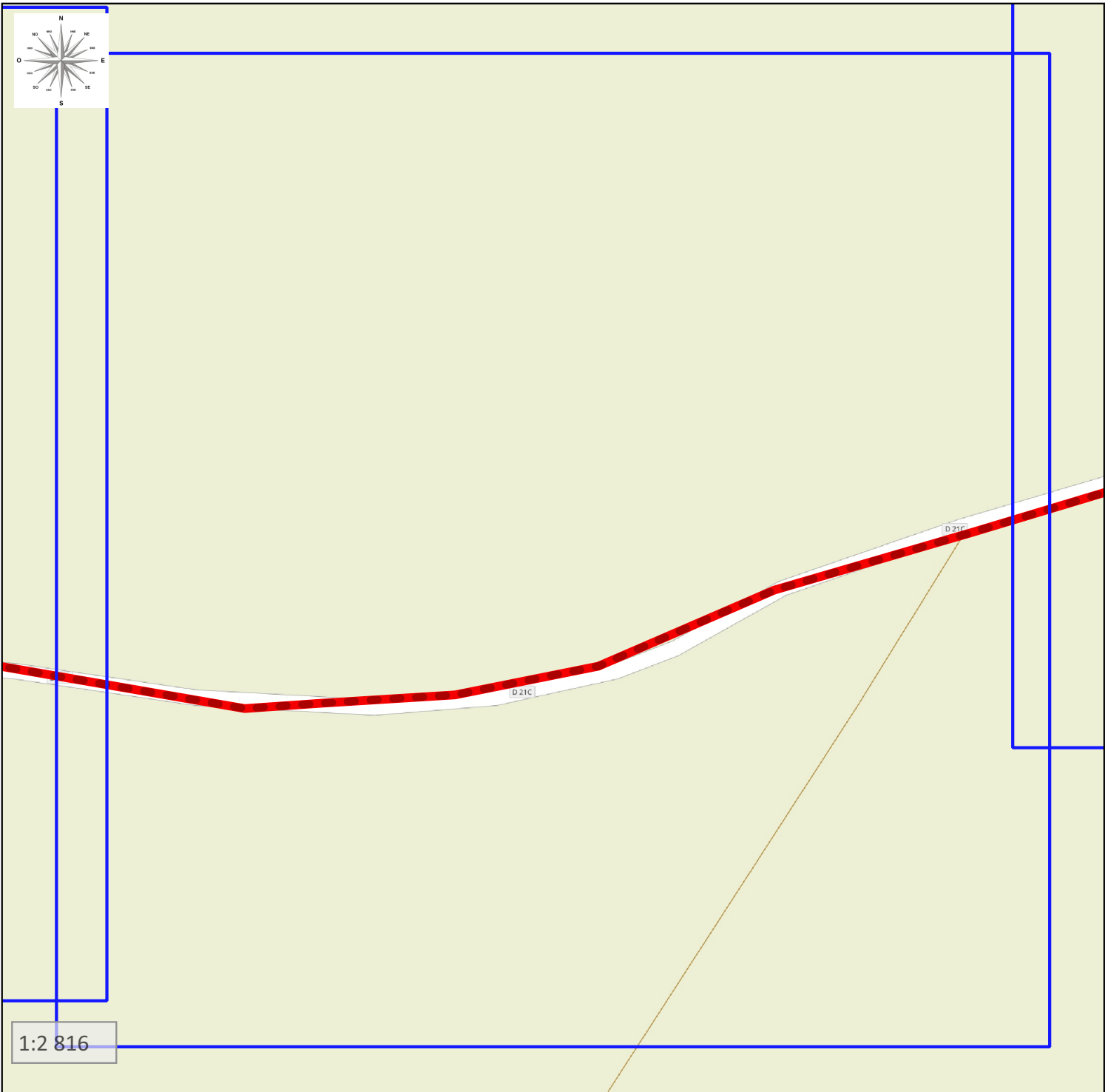

1:2 816

Synoptique GC
D21C

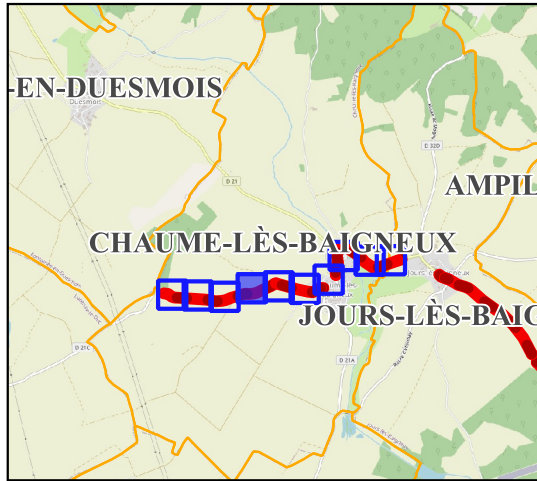

Légende :

GC

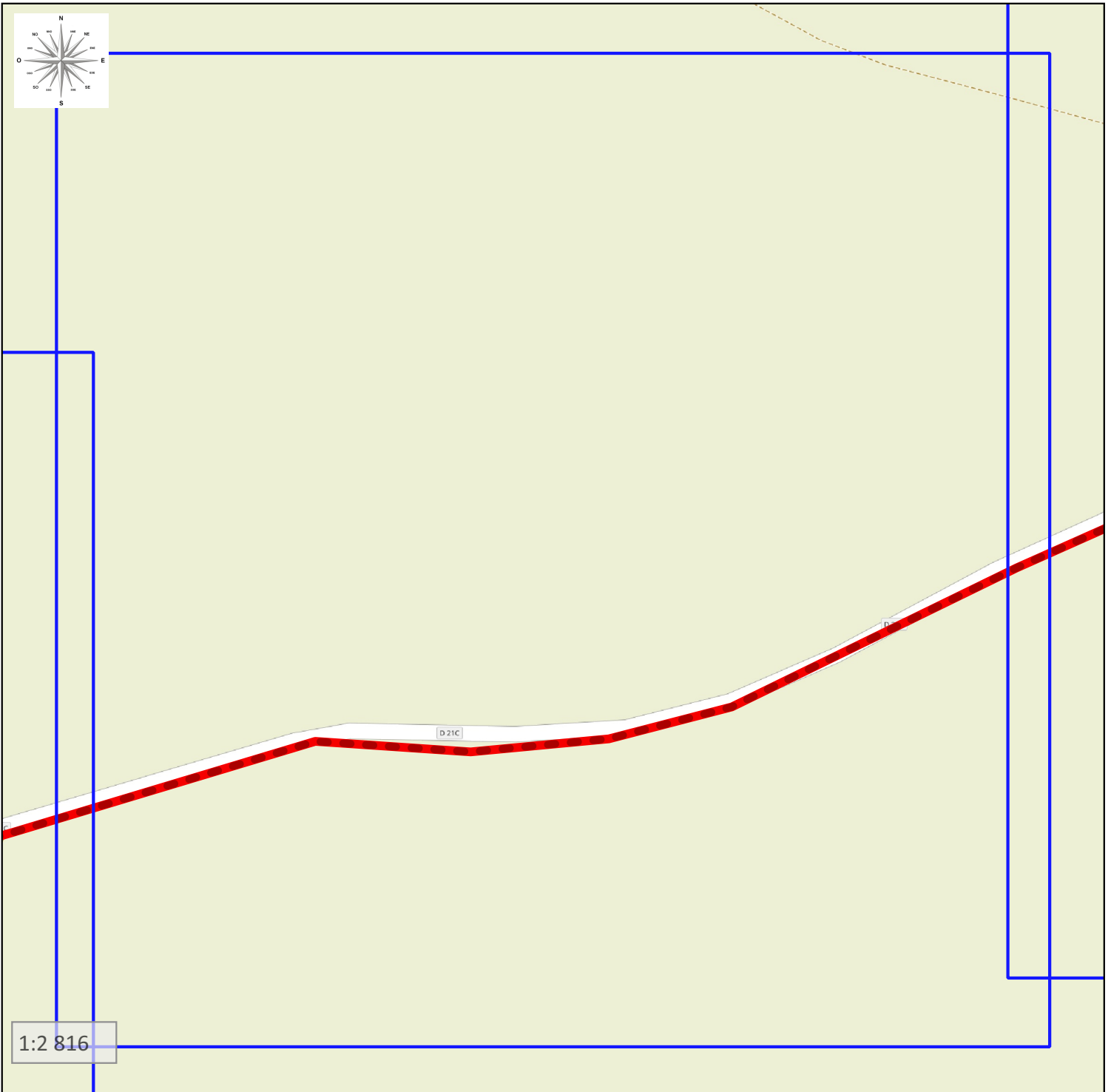

Synoptique GC
D21C

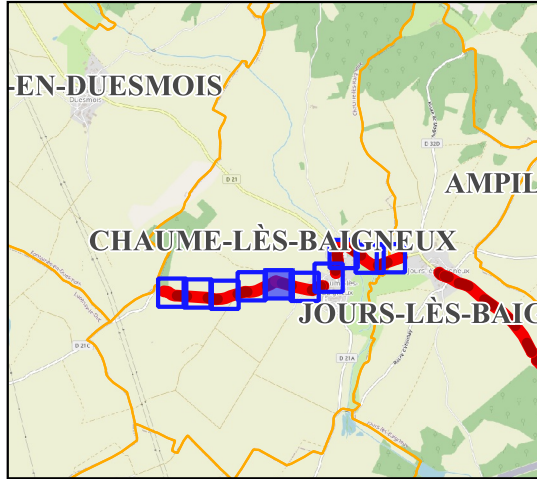

Légende :

GC

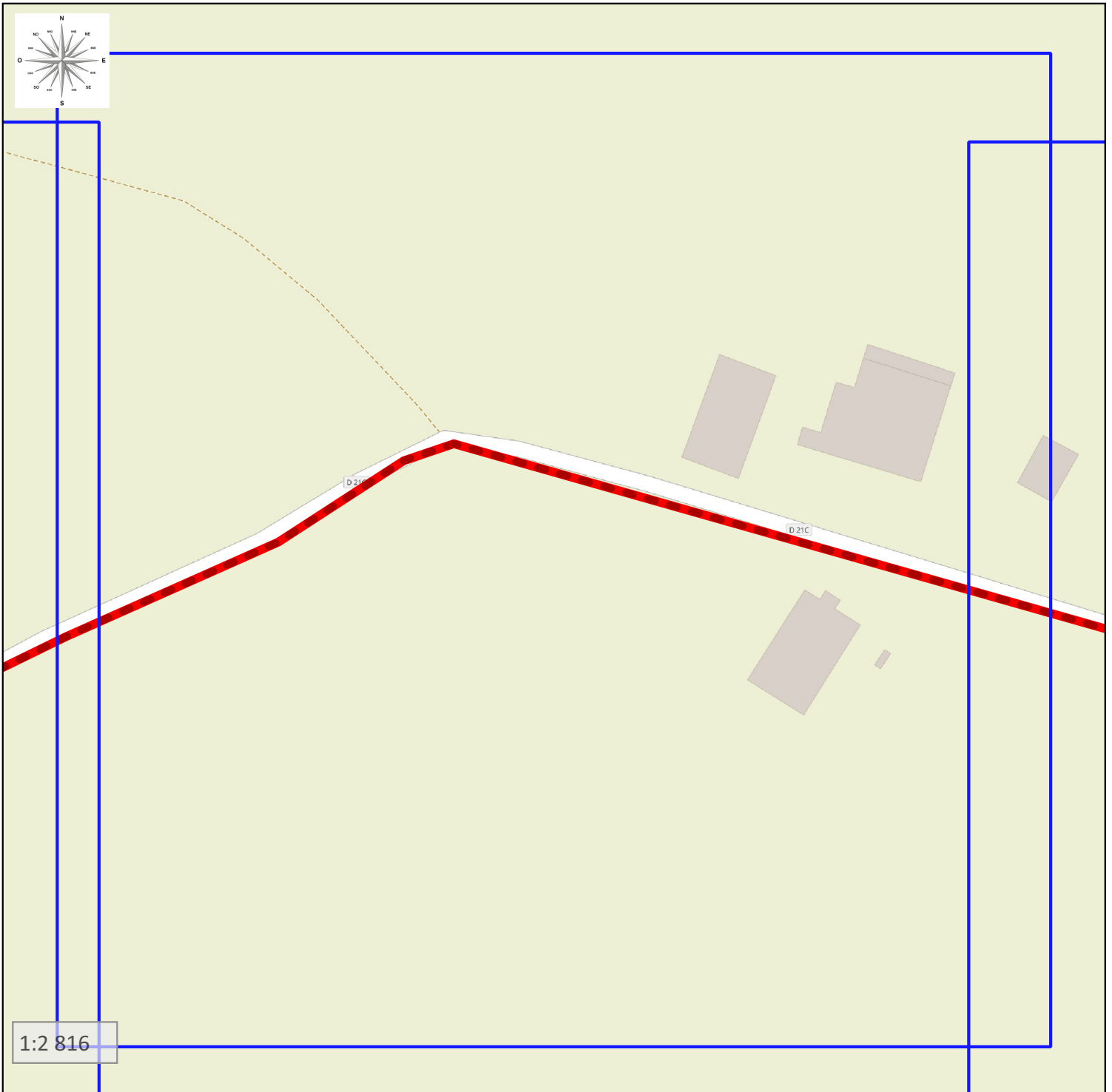

Synoptique GC
D21C

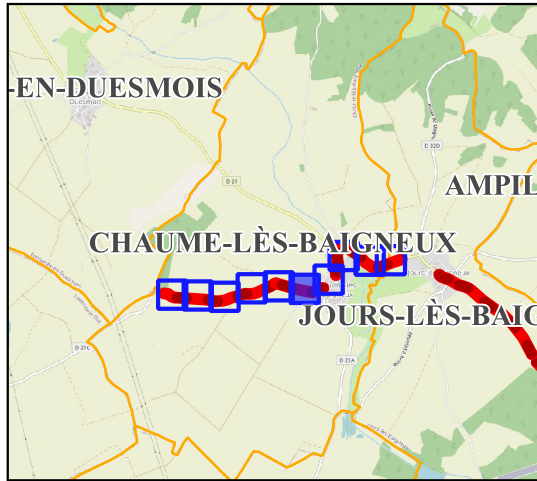

Légende :

GC

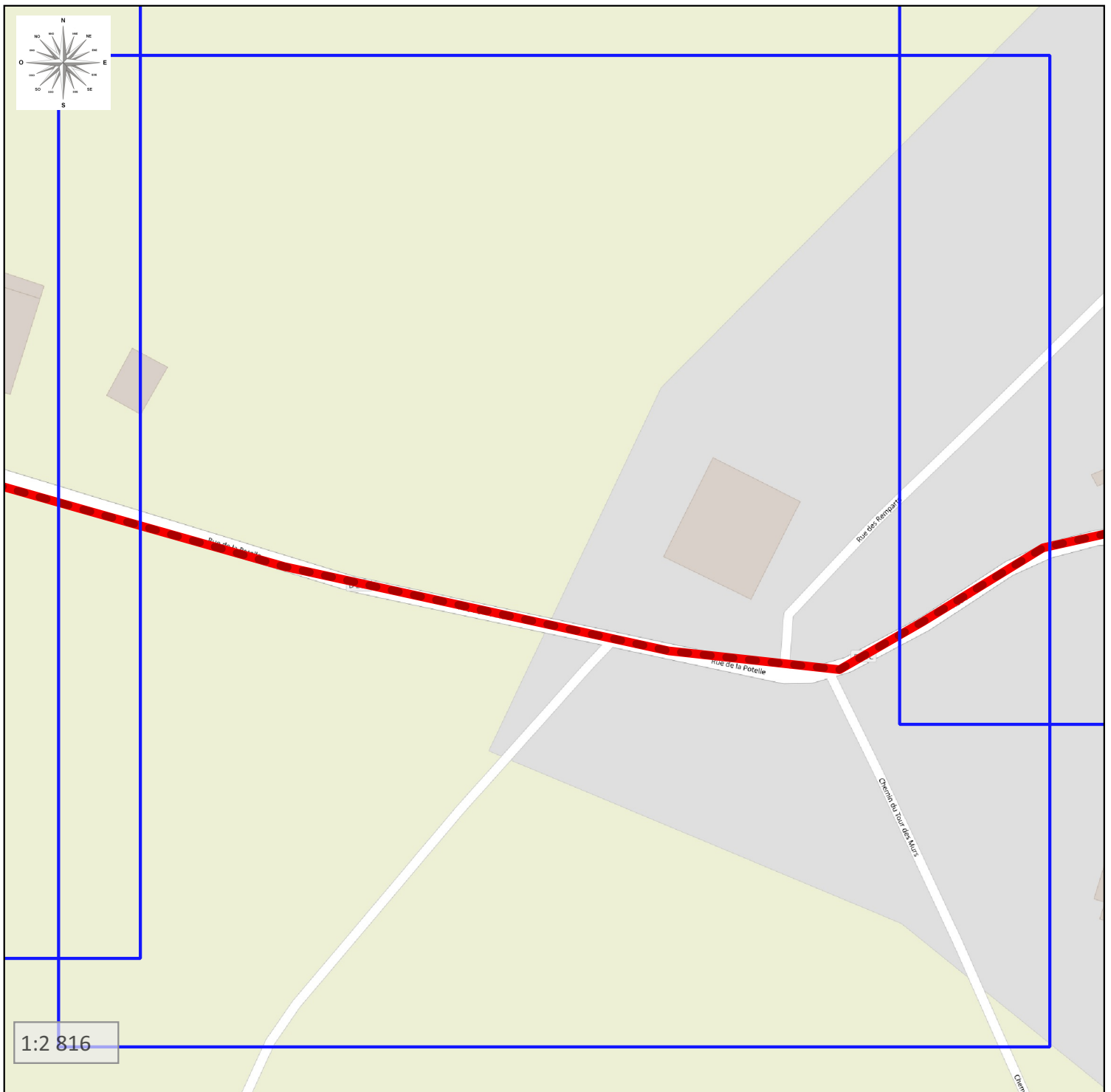

Synoptique GC
D21C ; D21

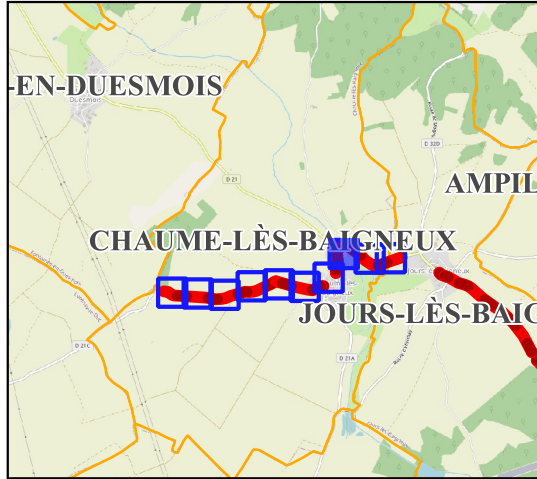

Légende :

GC

The legend consists of a red line segment followed by the text 'GC'.

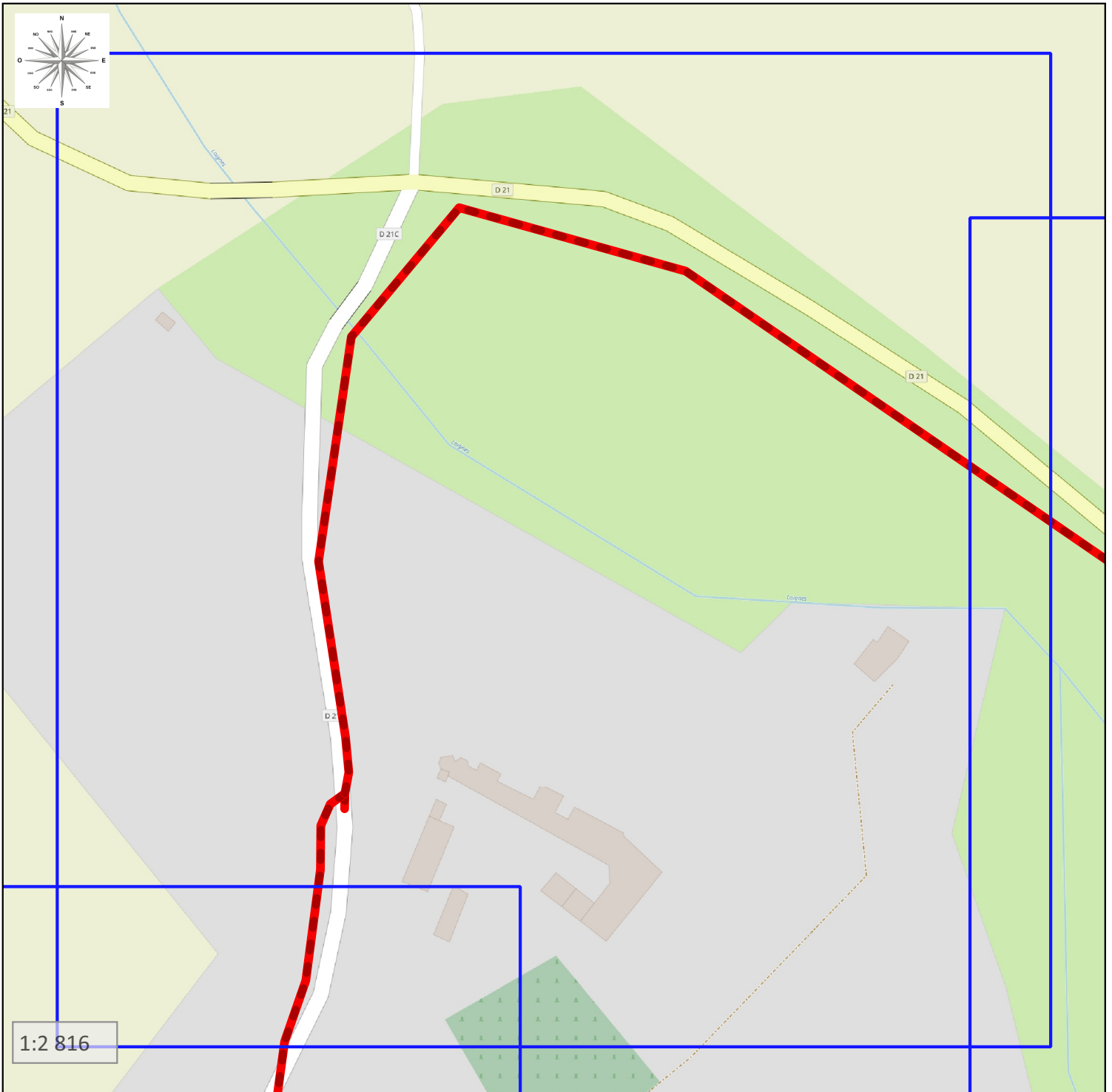

Synoptique GC
D21

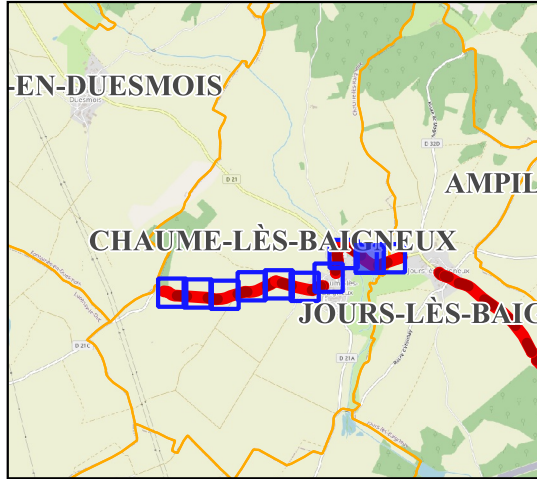

Légende :

GC

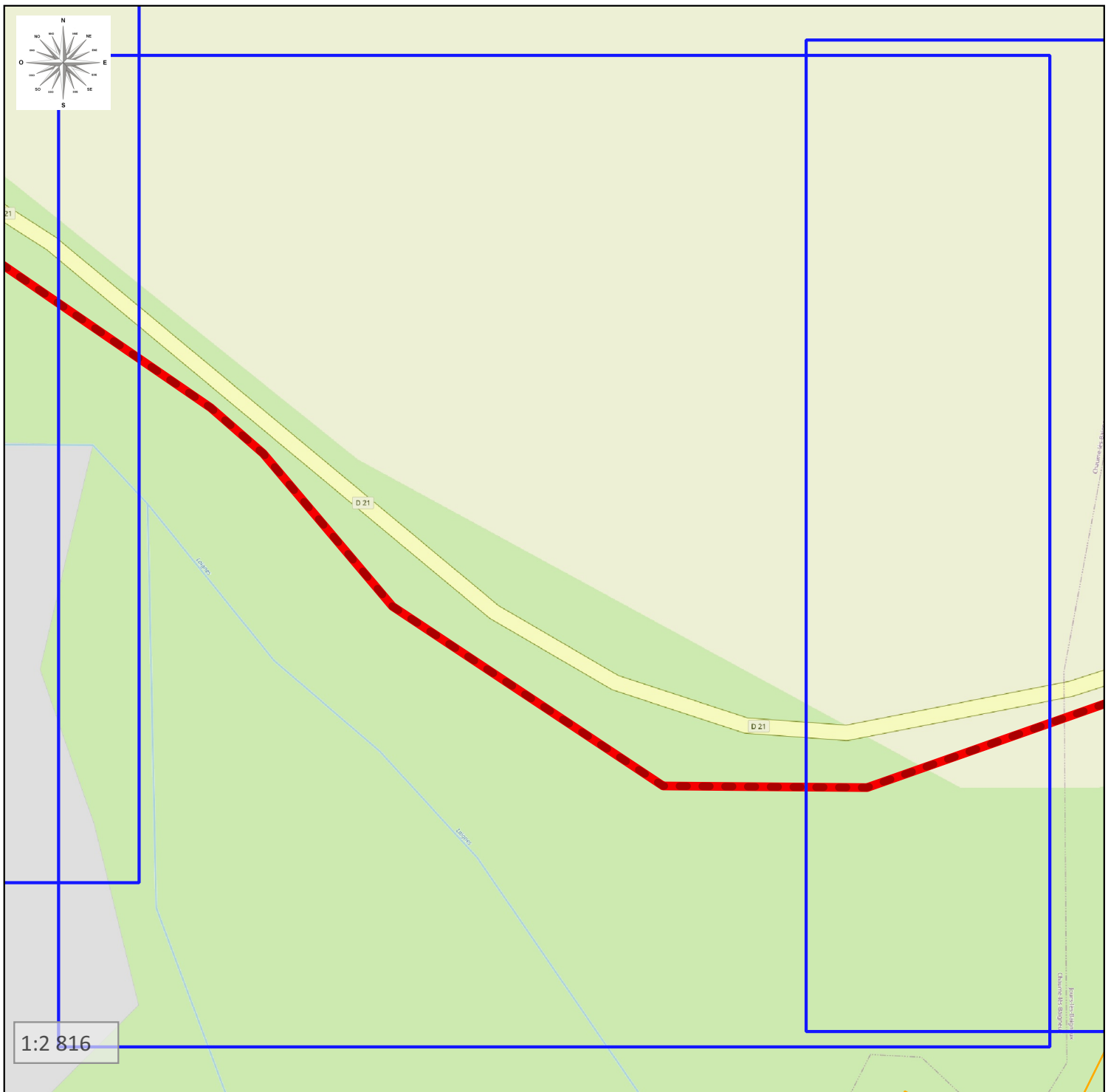

Synoptique GC
D21

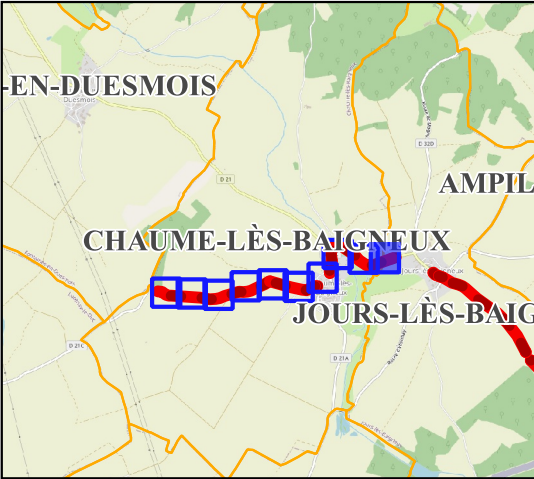

Légende :

- GC

